

Cnc machining are on the internal side of enclosure. Reduce the thickness of surface until the measure of 0,5 mm *.

Lavorazione meccanica sul lato interno. Riduzione dello spessore fino alla misura di 0,5 mm *.

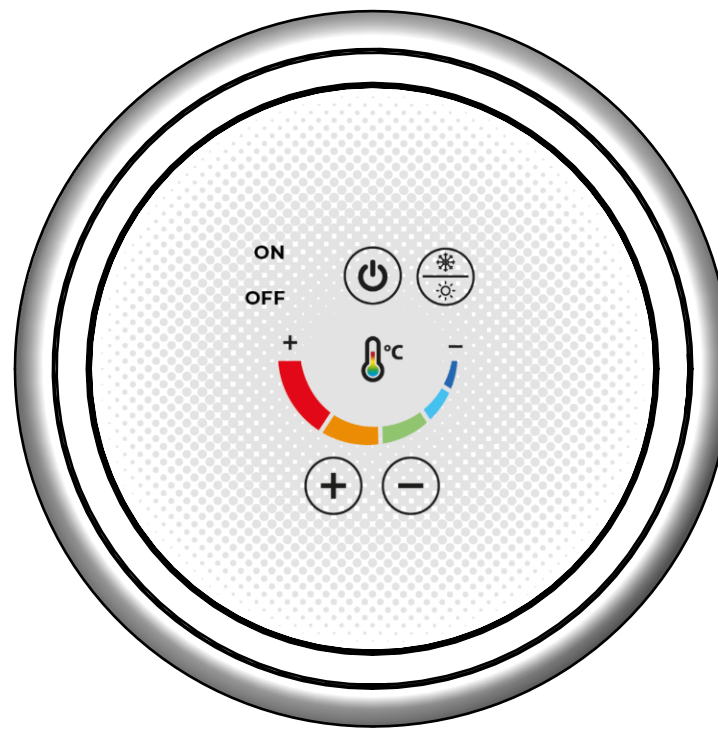

STAMPA DIGITALE

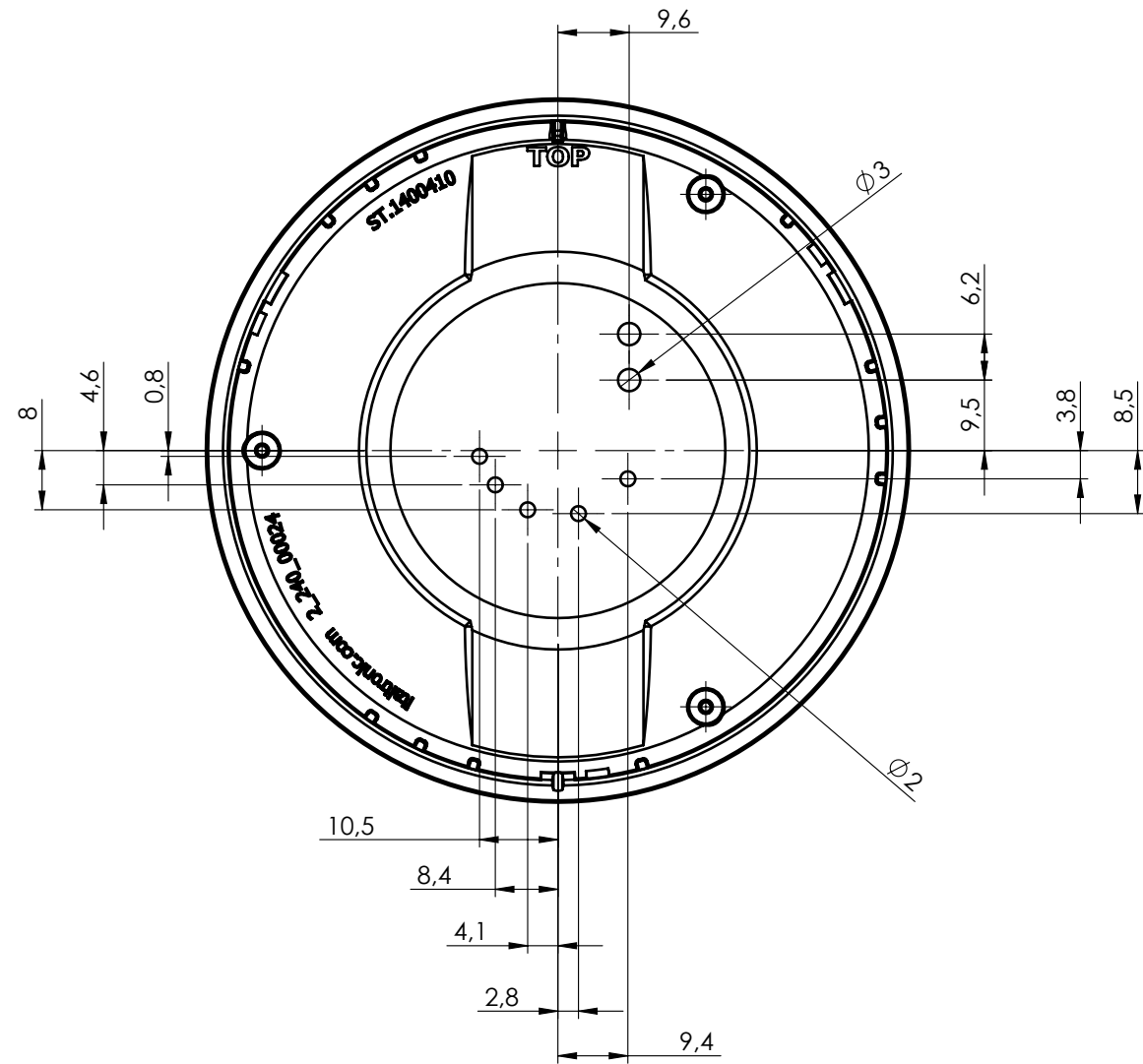
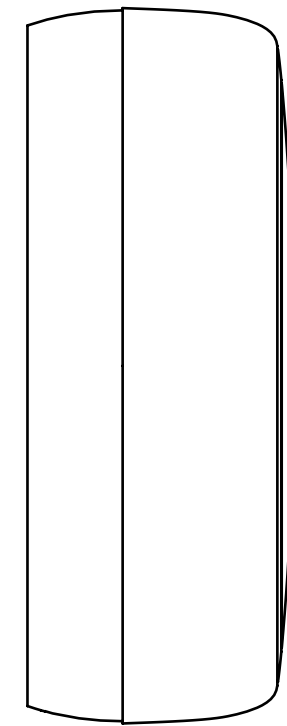

Revisions			
Rev.	Description	Date	Modified by
1	Removed kebab print.	27/05/2024	F.E.

* The machining of reducing the thickness of surface allows to see the light from LED that are welded on internal PCB without getting through the white enclosure.

* La lavorazione di riduzione spessore permette la visualizzazione di LED saldati sul PCB interno senza dover forare il contenitore bianco.

General Tolerance UNI EN 22768/1 Media (m)					Sheet:
from 0.5 to 3 ± 0.1	from 3 to 6 ± 0.1	from 6 to 30 ± 0.2	from 30 to 120 ± 0.3	from 120 to 400 ± 0.5	1/1
Scale: 1:1	Drawed: F.E.	Checked: R.N.	Date: 19/10/2020	Setup setting:	
Dimension in mm	The present drawing cannot be reproduced or communicated to 3rd parties, even partially, without the authorization of ITALTRONIC S.p.A. Italtronic reserves to protect its own rights according to the law.	Finishing code:	Type:		
Description: EYEBOS simple - WHITE					
Drawing nr. L_240_09155					Rev. 01 A3

