

COMPONENTS LIST			
RIF.	Q.TY	DESCRIPTION	CODE
1	1	BASE 4M-XT	M-01990
2	1	AGGANCIO MODULBOX - HOOK MODULBOX	M-01900
3	1	CORPO CONTENITORE 4M53-C - BODY ENCLOSURE 4M53-C	M-02012

Da 0,5 a 3	Oltre 3 fino a 6	Oltre 6 fino a 30	Oltre 30 fino a 120	Oltre 120
± 0,1	± 0,1	± 0,2	± 0,3	± 0,5

RESERVED PROPERTY

The present drawing cannot be reproduced or communicated to 3d parties, even partially, without the authorization of ITALTRONIC Srl. Italtronic reserves to protect its own rights according to the law.

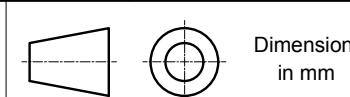

Dimension in mm

SHEET NR.
1 / 1

DRAWING BY
GAD
Manual modification are not allowed

GENERAL TOLERANCE
UNI EN 22768/1
Media (m)

Date: 29/08/2012

Replace nr.

Drawed: Reginato M.

Checked: Dalla Montà D.

Scale:

5	4	3	2	1
Revision description				

<p>UN PARTNER PER IL FUTURO</p>	Denomination:
	<p>Contenitore completo modulbox XT 4M53-C</p> <p>Complete enclosure modulbox XT 4M53-C</p>
<p>VIA AUSTRIA 25/D 35127 PADOVA - ITALY www.italtronic.com</p>	<p>Drawing nr.</p> <p>M-04075-01</p>

General revision and added table. 13/06/13 Rigato N.